

LEISURE VILLAGE WEST ASSOCIATION
MANCHESTER, NEW JERSEY

SPECIFICATION NO. 3_3

SPECIFICATION FOR INSTALLATION OF AN OUTSIDE DOOR
FROM PATIO TO GARAGE IN GREENERY MODELS,
WHEATON, STRATFORD, BLAIR HASTINGS

Since the Garage wall is a load-bearing, construction shall include a double 2" x 12" or suitable header to permit a 6' -10 1/4" high rough framed opening for 6' - 8" x 2'-8" in-swing door. See Fig. 3. "Peachtree" A300 in-swing complete door and frame assembly is recommended, component purchase and carpenter framed, finish trimmed, and installed with weather stripping and hardware is permitted but must meet the below specification requirements.

SPECIFICATIONS

1. Door shall be steel faced, polyurethane insulated bonded to a 1 3/4" thickness on pile stiles and top rail with steel with neoprene seal bottom rail.
2. Frame shall be toxic-treated pine mortised for hinges and lock strikes; strike mortise reinforced with steel security plate.
3. Sill shall be adapted to in-swing door, aluminum outside drain and oak inside in contact with bottom door seal.
4. Hinges shall be three 4" butt steel, removable pins, fully mortised to jamb and door edge, dull brass finished.
5. Weather stripping shall be polyethylene-covered foam compression type.
6. Astragals shall be toxic treated pine. Side & head jam astragals fitted with a J-channel at vertical astragals and with a Drip Cap at the header jam astragal.
7. Installation shall be painted one prime coat and one finish coat. Outside to be painted a color suitable to existing exterior doors.

THE RESPONSIBILITY FOR MAINTENANCE OR REPAIR OF THIS IMPROVEMENT IS THAT OF THE OWNER/SUBSEQUENT OWNER AND NOT THAT OF LEISURE VILLAGE WEST ASSOCIATION. The Association reserves the right to inspect the completed installation.

Municipal Permit Requirements: A few improvements, modifications or repairs are of a nature to require assurance that they conform to the NJ Uniform Construction Code which means that a Manchester Township Building Permit must be obtained before the work is started.

Dated: March 15, 1995

LEISURE VILLAGE WEST ASSOCIATION
 MANCHESTER, NEW JERSEY

SPEC. #40
 3/15/95

Page 2 -

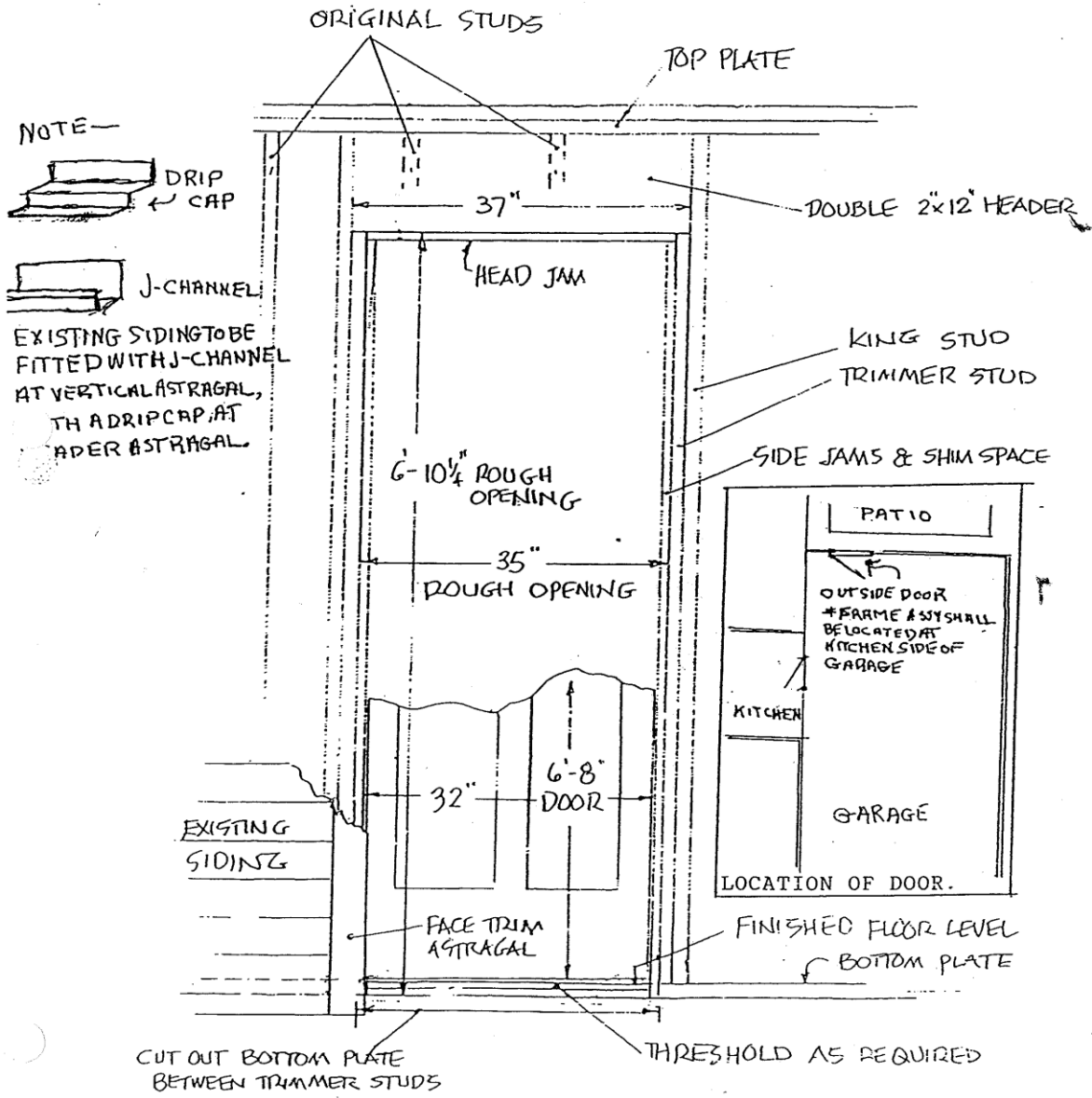

FRAMING FOR 2'-8" DOOR
 IN LOAD-BEARING WALL