

NOTES

1. The proposed Condominium is located on the 4.53 acre parcel shown on the attached site plan.
2. The proposed Condominium is located on the 4.53 acre parcel shown on the attached site plan.
3. The proposed Condominium is located on the 4.53 acre parcel shown on the attached site plan.
4. The proposed Condominium is located on the 4.53 acre parcel shown on the attached site plan.
5. The proposed Condominium is located on the 4.53 acre parcel shown on the attached site plan.
6. The proposed Condominium is located on the 4.53 acre parcel shown on the attached site plan.
7. The proposed Condominium is located on the 4.53 acre parcel shown on the attached site plan.
8. The proposed Condominium is located on the 4.53 acre parcel shown on the attached site plan.
9. The proposed Condominium is located on the 4.53 acre parcel shown on the attached site plan.
10. The proposed Condominium is located on the 4.53 acre parcel shown on the attached site plan.

OCEAN COUNTY PLANNING BOARD
4/22/17

MANCHESTER TOWNSHIP PLANNING BOARD
4/22/17

LEISURE TECHNOLOGY NORTHEAST, INC.
4/22/17

5/18/16

MANCHESTER TOWNSHIP PLANNING BOARD
4/22/17

LEISURE TECHNOLOGY NORTHEAST, INC.
4/22/17

4/22/17

4/22/17

4/22/17

4/22/17

4/22/17

LEISURE VILLAGE WEST MANCHESTER TOWNSHIP, OCEAN COUNTY, N.J.	4/22/17
FINAL MAP OF LEISURE VILLAGE WEST CONDOMINIUM NO 22 AMENDED	4/22/17

Blg No	Area	Permit	Area	Permit	Area	Permit
101	100	100	100	100	100	100
102	100	100	100	100	100	100
103	100	100	100	100	100	100
104	100	100	100	100	100	100
105	100	100	100	100	100	100
106	100	100	100	100	100	100
107	100	100	100	100	100	100
108	100	100	100	100	100	100
109	100	100	100	100	100	100
110	100	100	100	100	100	100
111	100	100	100	100	100	100
112	100	100	100	100	100	100
113	100	100	100	100	100	100
114	100	100	100	100	100	100
115	100	100	100	100	100	100
116	100	100	100	100	100	100
117	100	100	100	100	100	100
118	100	100	100	100	100	100
119	100	100	100	100	100	100
120	100	100	100	100	100	100
121	100	100	100	100	100	100
122	100	100	100	100	100	100
123	100	100	100	100	100	100
124	100	100	100	100	100	100
125	100	100	100	100	100	100
126	100	100	100	100	100	100
127	100	100	100	100	100	100
128	100	100	100	100	100	100
129	100	100	100	100	100	100
130	100	100	100	100	100	100
131	100	100	100	100	100	100
132	100	100	100	100	100	100
133	100	100	100	100	100	100
134	100	100	100	100	100	100
135	100	100	100	100	100	100
136	100	100	100	100	100	100
137	100	100	100	100	100	100
138	100	100	100	100	100	100
139	100	100	100	100	100	100
140	100	100	100	100	100	100
141	100	100	100	100	100	100
142	100	100	100	100	100	100
143	100	100	100	100	100	100
144	100	100	100	100	100	100
145	100	100	100	100	100	100
146	100	100	100	100	100	100
147	100	100	100	100	100	100
148	100	100	100	100	100	100
149	100	100	100	100	100	100
150	100	100	100	100	100	100
151	100	100	100	100	100	100
152	100	100	100	100	100	100
153	100	100	100	100	100	100
154	100	100	100	100	100	100
155	100	100	100	100	100	100
156	100	100	100	100	100	100
157	100	100	100	100	100	100
158	100	100	100	100	100	100
159	100	100	100	100	100	100
160	100	100	100	100	100	100

AMENDED
CONDOMINIUM NO. 19

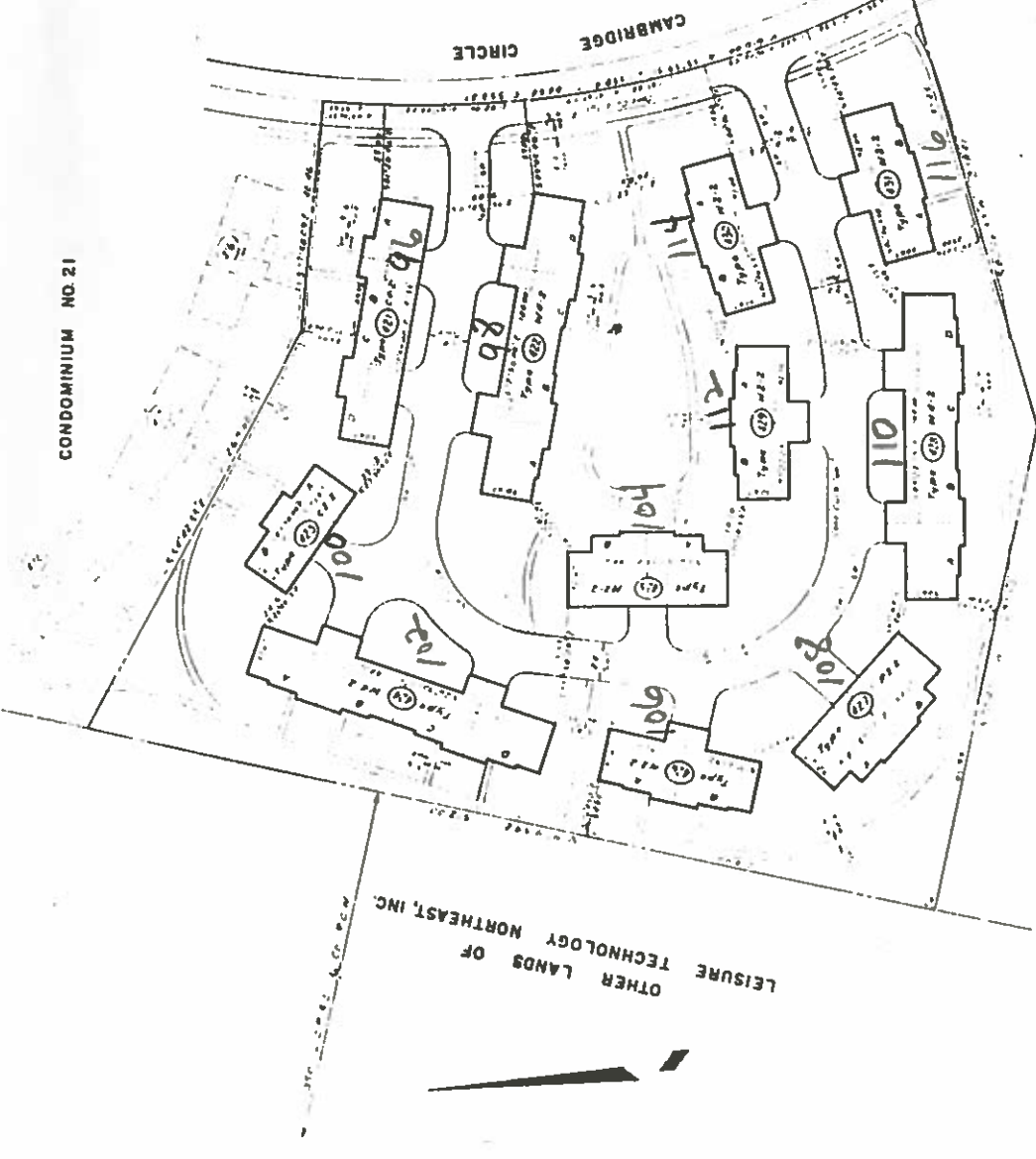

RESERVED FOR FUTURE CONDOMINIUM

4/22/17
Leisure Technology Northeast, Inc.



FRONT OF BLDG
TYPE R2-2



FRONT OF BLDG
TYPE C2-2



FRONT OF BLDG
TYPE C4-2



FRONT OF BLDG
TYPE W2-2



FRONT OF BLDG
TYPE W4-2

2-7
4-4