

BLDG. NO.	UNIT	SOURCE	FIN. FV.	FIN. CUL.
1186	A	1480	67.80	28.92
1186	B	1480	67.80	28.92
1187	A	1487	67.80	28.92
1187	B	1487	67.80	28.92
1188	A	1488	67.80	28.92
1188	B	1488	67.80	28.92
1189	A	1489	67.80	28.92
1189	B	1489	67.80	28.92
1190	A	1490	67.80	28.92
1190	B	1490	67.80	28.92
1191	A	1491	67.80	28.92
1191	B	1491	67.80	28.92
1192	A	1492	67.80	28.92
1192	B	1492	67.80	28.92
1193	A	1493	67.80	28.92
1193	B	1493	67.80	28.92
1194	A	1494	67.80	28.92
1194	B	1494	67.80	28.92
1195	A	1495	67.80	28.92
1195	B	1495	67.80	28.92
1196	A	1496	67.80	28.92
1196	B	1496	67.80	28.92
1197	A	1497	67.80	28.92
1197	B	1497	67.80	28.92
1198	A	1498	67.80	28.92
1198	B	1498	67.80	28.92
1199	A	1499	67.80	28.92
1199	B	1499	67.80	28.92

Note: Fin Ceiling Plan shown as min. as shown on Architect's Plans. It classifies reflect. Cathedral Ceilings.

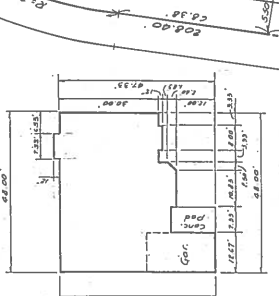

FRONT OF BLDG. TYPE 40

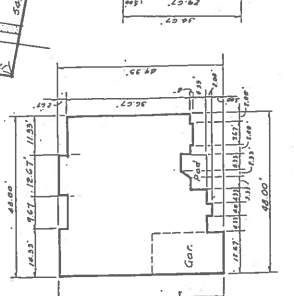

FRONT OF BLDG. TYPE 50

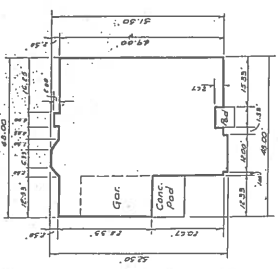

FRONT OF BLDG. TYPE 60

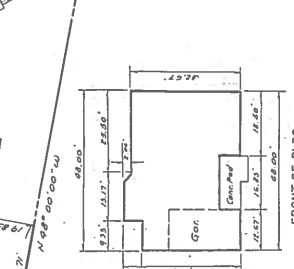

FRONT OF BLDG. TYPE 10



FRONT OF BLDG. TYPE 30

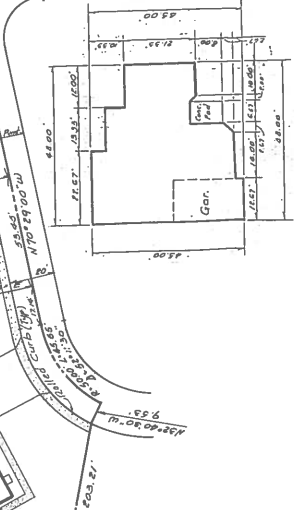

FRONT OF BLDG. TYPE 20

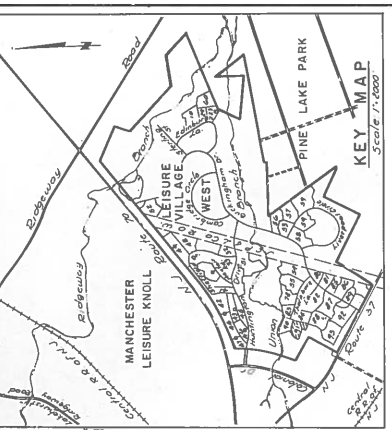

NOTES

- All elevations shown are to 0.50' 0.00' datum.
- All elevations shown are proposed as of 4/17/87.
- All elevations within the limits of this tract will be under private ownership.
- All improvements shown are proposed as of 4/17/87.
- Condominium 91 contains 30 units.
- Condominium 92 contains 30 units.
- [S.P.] indicates service and utility parking permitted for unattended vehicles prohibited from parking on car service drives.

Approved By  
MANCHESTER TOWNSHIP PLANNING BOARD  
Date 4/17/87

John A. Mason  
Vice Chairman  
Mark Kennedy  
Secretary  
4/17/87  
Date

I certify that the Manchester Township Planning Board has approved this map for filing in the Ocean County Clerk's office provided this map is filed on or before July 13, 1987.  
4/17/87  
M. J. [Signature]  
Secretary

I have carefully examined this map and find it conforms with the provisions of the municipal ordinances and requirements applicable hereof.  
4/17/87  
Date

I hereby certify that we are the record holders of title to the lands delineated on this map and approve the filing hereof.  
4/17/87  
Date

LEISURE + TECHNOLOGY, INC.  
Municipal Engineer

The Survey shown hereon and the plans annexed hereto as Exhibit C constitute a correct representation of the improvements shown hereon.

Donald W. Smith  
Secretary

LEISURE VILLAGE WEST  
MANCHESTER TOWNSHIP, OCEAN COUNTY, N.J.  
AMENDED FINAL MAP OF  
LEISURE VILLAGE WEST  
CONDOMINIUM NO. 91

APPROVED BY: 3/19/87  
DATE: 4/17/87  
BY: J.A.M.  
J.L.C.  
C.E.T.  
D.W.S.  
P.H.B.  
S.H.B.  
S.H.B.  
S.H.B.

PREPARED BY: Donald W. Smith  
PLANNERS - SURVEYORS  
ENGINEERS - PLANNERS - SURVEYORS  
MANASSAS, VA 22108  
4010 Airport Road, Catonsville, MD 21038

15-8